

未注公差/General tolerances(mm)

0	>3	>6	>10	>18	>30	>50	>80	>120	>180	>250	>315	>400	>500	0.1/10 ±2'
~3	~6	~10	~18	~30	~50	~80	~120	~180	~250	~315	~400	~500		
±0.12	±0.18	±0.22	±0.26	±0.31	±0.37	±0.57	±0.80	±0.93	±1.05	±1.15	±1.60	±2.20	±2.50	

REV	ECN	DESCRIPTION	DRFT	DATE

PCB LAYOUT

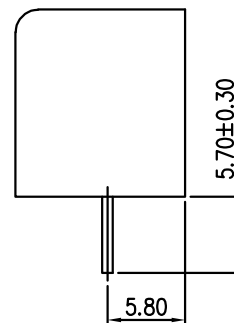
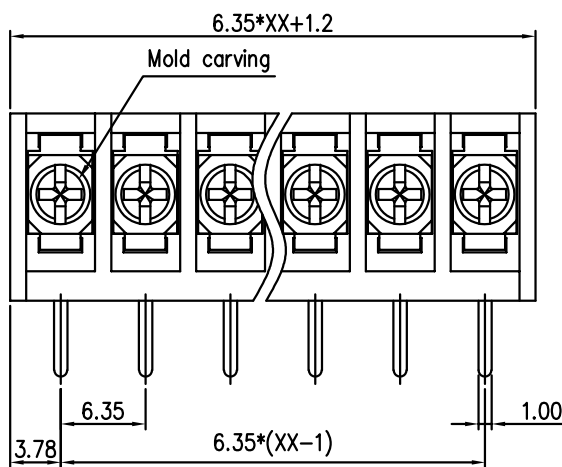
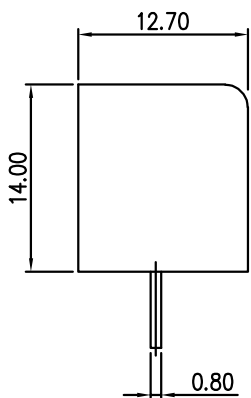
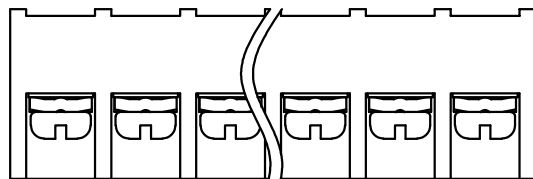
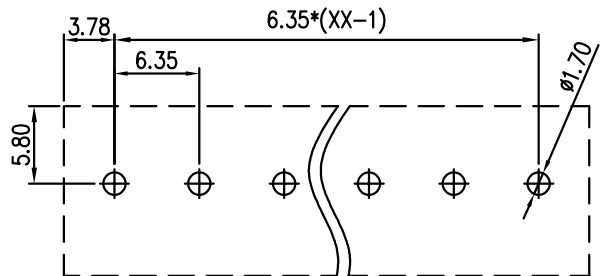

UL 标准/UL Standard:	B	C	D
额定电压/电流/Rated Voltage(V)/Current(A)	300/10	/	300/10
IEC 标准/IEC Standard:			
额定电压/电流/Rated Voltage(V)/Current(A)	250/17.5		
工频耐压/Withstanding Voltage	AC2000V/1Min		
螺丝扭矩/Torque Tightening(N·m/Lb.in)	M3, 0.5/4.43		
线径范围(硬线和软线)/Wire Range(rigid and flexible)(AWG/mm²)	22~16/1.5		
间距/Pitch(mm)/线数范围/Poles	6.35/XX=2~24P		
使用温度范围/Operating temperature(°C)	-40~+105		
符合RoHS环保要求/Conform to RoHS	Yes		

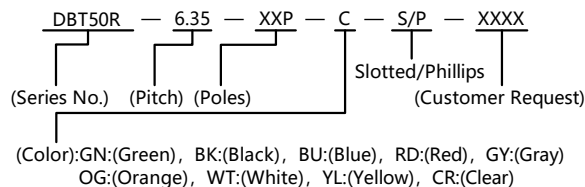

Screw	Steel	Zn Plated
Conductor	Copper alloy	Sn Plated
Insulator	PA66	UL94V-0
NAME OF PART	MATERIAL	NOTES

MAT NO.:	/		
STATUS:	/		
APPD: Steven Lu 2026.4.21	NAME: 宁波地博电气有限公司 NINGBO DORABO ELECTRIC CO., LTD		
CHKD: Jting Chen 2026.4.21	DBT50R-6.35-XXP-C-P		
DRFT: Tom Mao 2026.4.21	DRAWING NO.:	/	REV A
SIZE: A4	TYPE: CUSTOMER_DRAWING	SCALE: 1:1	SHEET 1/1