

| linear dimension(Tolerances Standard GB/T 14486-2008) |       |              |               |               |                |                 |             | —     | $\nabla$       | $\perp$     |
|---|-------|--------------|---------------|---------------|----------------|-----------------|-------------|-------|----------------|-------------|
| variable range  | to 6  | over 6 to 10 | over 10 to 30 | over 30 to 60 | over 60 to 100 | over 100 to 160 | over 160 to | to 10 | over 10 to 100 | over 100 to |
| tolerance   | ±0.20 | ±0.30        | ±0.50         | ±0.70         | ±1.00          | ±1.30           | ±1.60       | 0.10  | 0.30           | 0.60        |

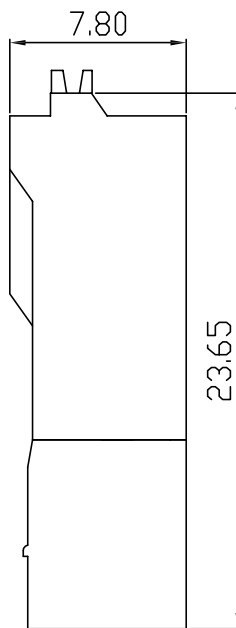
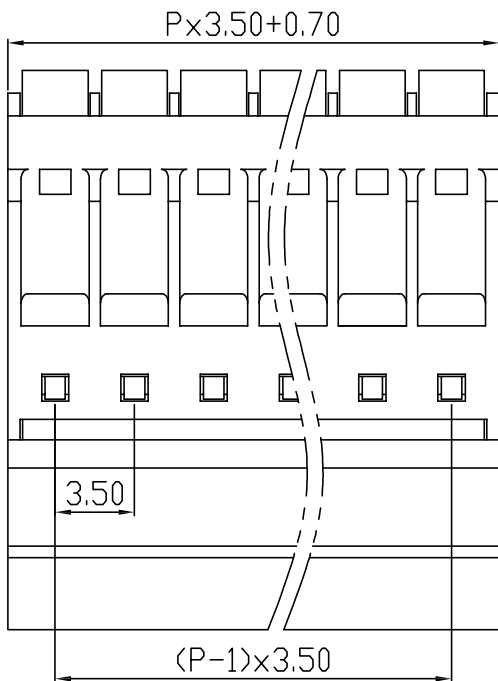
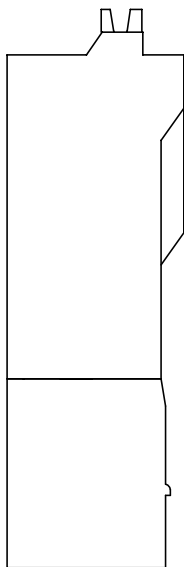
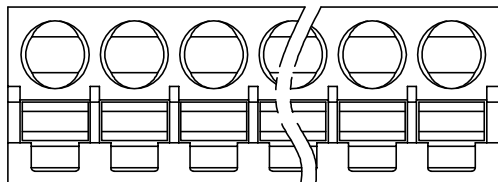

DB2EKNR — 3.5 — XXP — C

(Series No.) (Pitch) (Poles)

(Color):GN:(Green), BK:(Black), BU:(Blue), RD:(Red), GY:(Gray)  
OG:(Orange), WT:(White), YL:(Yellow), CR:(Clear)

|       |            |            |
|-------|------------|------------|
| APPD: | JTing Chen | 2022.11.23 |
| CHKD: | Duck Mao   | 2022.11.23 |
| DRFT: | Steven Lu  | 2022.11.23 |

|                        |                 |                                 |              |             |
|------------------------|-----------------|---------------------------------|--------------|-------------|
| <b>DORABO</b>          |                 | 宁波地博电气有限公司                      |              |             |
|                        |                 | Ningbo Dorabo Electric CO., Ltd |              |             |
| NAME:                  |                 | DB2EKNR-3.5-XXP-C               |              |             |
| $\oplus$               | $\triangleleft$ | SIZE: A4                        | mm<br>(inch) | REV         |
| TYPE: CUSTOMER_DRAWING |                 | SCALE: 1:1                      | SHEET        | T0-1<br>1/1 |

| UL/CUL 技术参数           |                                   | cRUus            |     |     |
|-----------------------|-----------------------------------|------------------|-----|-----|
| UL/CUL Technical Data |                                   | B                | C   | D   |
| 等级                    | Use Group                         | B                | C   | D   |
| 额定电压                  | Rated Voltage [V]                 | 300              | -   | 300 |
| 额定电流                  | Rated Current [A]                 | 8                | -   | 10  |
| 接线范围                  | Wire Range                        | 28-16            |     |     |
| 单/多芯线                 | Solid/Stranded [AWG]              |                  |     |     |
| 耐电压                   | Withstanding Voltage              | 1600V/1Min       |     |     |
| IEC 技术参数              |                                   |                  |     |     |
| IEC Technical Data    |                                   |                  |     |     |
| 过电压类别                 | Overvoltage Category              | III              | III | II  |
| 污染等级                  | Contamination Class               | 3                | 2   | 2   |
| 额定电压                  | Rated Voltage [V]                 | -                | 160 | 320 |
| 额定电流                  | Rated Current [A]                 | -                | 7   | 7   |
| 额定冲击电压                | Impulse withstand voltagea [KV]   | -                | 2.5 | 2.5 |
| 导线截面积                 | Conductor cross section           | 1.5              |     |     |
| 硬质/柔性导线               | Solid/flexible [mm <sup>2</sup> ] |                  |     |     |
| 材料                    |                                   |                  |     |     |
| 绝缘材料                  | Insulation Material               | PA66             |     |     |
| 阻燃等级                  | Imflamability                     | UL94V-0          |     |     |
| 导体材料                  | Contact Material                  | 铜合金 Copper alloy |     |     |
| 导体表面镀层                | Contactive Coating                | 镀锡 Sn Plated     |     |     |
| 一般参数                  |                                   |                  |     |     |
| 间距                    | Pitch [mm]                        | 3.5              |     |     |
| 极数                    | Poles [P]                         | 02-24            |     |     |
| 剥线长度                  | Stripping Length [mm]             | 8-9              |     |     |
| 螺丝                    | Screw/扭矩 Torque(Max) [N.m]        | -                |     |     |
| 工作温度                  | Operating temperatur [°C]         | -40~+105         |     |     |
| 引针尺寸                  | Pin Dimensions [mm]               | -                |     |     |
| PCB板孔径                | PCB Hole Diameter [mm]            | -                |     |     |